

# 81 EAST VAN BUREN







# SMALL BUT SOPHISTICATED

Located in the historic Chicago Club, the spaces at 81 East Van Buren offer unparalleled frontage on Van Buren and Michigan Avenue near Grant Park. With gold details along the entryways and interior, these retail spaces are perfect for attracting deep pockets.

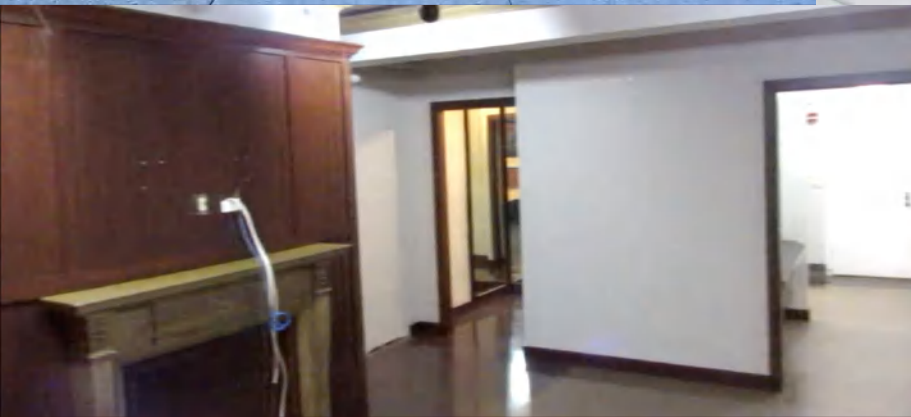





# About the East Loop

*A retailer's dream location*

81 East Van Buren is proximate to all CTA lines, buses, the Pedway, and parking, with the entrance to the Van Buren Metra Station at its doorstep. Other nearby highlights include Grant Park, some of Chicago's finest cultural attractions such as the Art Institute and Chicago Symphony Orchestra, Harold Washington Library, State Street and Michigan Avenue shopping, and a rapidly growing population of residents, students, and visitors.

## *Demographic Information (2 Miles)*

2020 Population	238,419
Projected Growth (2020-2025)	1.1%
Median Age	36.4
2020 Households	134,586
Avg Household Size	1.6
Avg Household Income	\$137,522
Top Consumer Spending	Food & Alcohol



# Neighborhood Features

## *Dining, shopping, tourism, and entertainment*

Besides parking and public transportation, within a few blocks of 81 East Van Buren are convenience stores, coffee shops, both casual and luxury dining, the Art Institute, Robert Morris University, Roosevelt University, Columbia College, John Marshall Law School, and DePaul University. Other features include the Congress Plaza Hotel, The Blackstone Hotel, and the Hilton Chicago.



**Jonathan Zimmerman**  
jzimmerman@willardjones.com  
312-263-8787  
WillardJones.com

